

Conference Topics

The Christian Roots Of Science & Busting The Myths Of Evolution

Why did science flourish in the West, and only the West? The biblical worldview provided the presuppositions that allowed science to flourish while it was stillborn in other places such as Greece and China.

Science Or 'Spin'? Real Science Supports The Bible!

This lecture explores the distinction between 'origins science' which seeks to explain what happened in the past and 'operational science' which is testable, repeatable, and is the source of things like cell phones and antibiotics.

Mutations & Darwinism

Evolution is true, but going the wrong way. The problem with evolution has never been the survival of the fittest, but the arrival of the fittest, and this is still the most serious problem today with Darwinism.

Slaughter Of The Dissidents

Charles Darwin's ideas still penetrate every aspect of our culture. Little has been publicized about the dark side of the man himself and how this may have impacted the quality and legitimacy of his research.

Our Young Universe

You probably know that the Bible describes a young Earth. In this presentation, we'll review evidence for our Solar System and Universe being young, in accordance with the Biblical account of Creation.

The Big Bang Never Happened

In this presentation, we'll examine the Big Bang theory. We'll see that it not only lacks solid evidence, it also contradicts several important laws of science. Overall we'll see that the Big Bang is not a good scientific model.

Fossils: History In Contention

Secular geologists have rejected Biblical history and assert that there has been no global flood as described in Genesis. This presentation provides the Biblical answer to the fossil record and an encouragement for Christians to trust in the Bible as authoritative on early Earth history.

Genesis: Fables Or Foundation Of Our Faith?

Does the bible support billions of years? Was the flood of Noah a global event? This talk is a defense of the literal Biblical worldview, and offers encouragement for Christians to trust in the Bible as authoritative.

Schedule

FRIDAY, MAY 31	
6:30 PM	DOORS OPEN
7:00 PM	Jonathan Sarfati Science Or 'Spin'? Real Science Supports The Bible!
8:10 PM	Spike Psarris Our Young Universe
9:20 PM	Star Gazing with Spike Psarris and Mark Osterhaus (weather permitting)
SATURDAY, JUNE 1	
8:30 AM	DOORS OPEN
9:00 AM	Chris Ashcraft Genesis: Fables Or Foundation Of Our Faith?
10:10 AM	Jerry Bergman Mutations & Darwinism
11:20 AM	Spike Psarris The Big Bang Never Happened
12:20 PM	LUNCH
1:10 PM	Jonathan Sarfati The Christian Roots Of Science
2:20 PM	Chris Ashcraft Fossils: History In Contention
3:30 PM	Jerry Bergman Slaughter Of The Dissidents
4:30 PM	CLOSE

During breaks, guests are encouraged to browse the creation resources offered for sale at the conference. A large assortment of books, DVDs, and curriculum will be made available for continuing education in Biblical apologetics.



nwcreation.net/conference

In the beginning God created...

Seattle CREATION CONFERENCE 2013



MAY 31 - JUNE 1, 2013

Seattle CREATION CONFERENCE 2013

When

Friday, May 31st 6:30pm – 9:30pm
Saturday, June 1st 8:30am – 4:30pm

Where

Woodin Valley Baptist Church
5400 228th Street S.E.
Bothell, WA 98021
woodinvalleybaptist.org

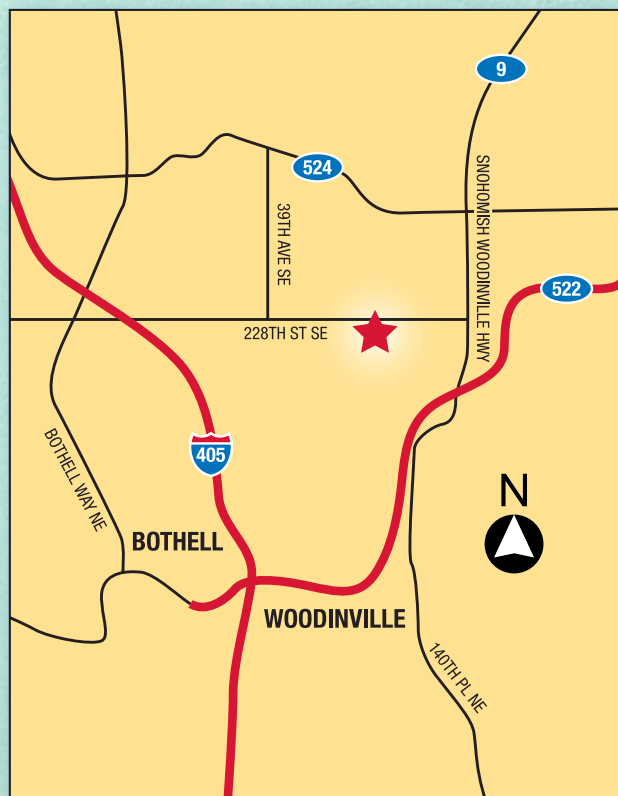

Speakers



Jonathan Sarfati

Jonathan studied science at Victoria University of Wellington. He obtained a B.Sc. (Hons.) in Chemistry. His Ph.D. was in Chemistry. In 2004, he wrote *Refuting Compromise*, defending a straightforward biblical creation timeline and a global flood, and answering biblical and scientific objections. Dr. Sarfati is also a former New Zealand Chess Champion.



Jerry Bergman

Jerry is an adjunct associate professor at Medical University of Ohio and an instructor in the Division of Arts & Sciences at Northwest State Community College in Archbold, Ohio. He teaches biochemistry, biology, chemistry and physics. He has taught at the college level for 35 years including 7 years at Bowling Green State University, 6 years at the University of Toledo, and 20 years at Northwest State.



Spike Psarris

Spike has a Bachelor's of Science in Electrical Engineering from the University of Massachusetts, and has done graduate work in Physics. For a number of years, he was an engineer in the U.S. military space program; he entered that position as an atheist and committed evolutionist, and came out of it as a young-earth creationist and Christian.



Chris Ashcraft

Chris obtained an MS in biology from Texas Tech, an M.Ed. from UW, and an MTMS from SPU. He is a high school science teacher at Cedar Park Christian Schools, and previously worked in biotechnology where he specialized in genetic transformations. He also speaks on creation apologetics at regional churches, Christian schools, teacher conventions, and creation organizations.

Mission Statement

The Seattle Creation Conference is a two day event dedicated to glorifying God through the scientific study of His creation, and refuting the false claims of evolutionism.

Conference Cost

The conference is provided free of charge. However, we suggest that attendees pay a \$20 donation per person to help cover the cost of this important event. These funds help pay for publicity, facility costs, plus speaker honorariums and travel expenses. Preregistration helps provide the funds necessary for publicity, and the books and videos made available for sale at the conference.

What Is Included

Guest are welcome to attend any of the general session lectures.

Lunch

Lunch options will be available Saturday in the Church cafe, and free snacks will be provided throughout the day.

Two Ways To Register

- 1) Register at <http://store.nwcreation.net/registration.html>. Major credit or debit cards accepted for \$20 donation.
- 2) Register at the door on the day of the conference.

Attention Teachers

Teacher CEU's and Washington State Clock Hours will be available.

More Information

For more info visit nwcreation.net/conference or call Chris Ashcraft at (206) 465-1635 or email him at ashcraft@nwcreation.net.

nwcreation.net/conference